



3 Maple Avenue

Ulverston, LA12 9JZ

Offers In The Region Of £195,000



2



1



2



c

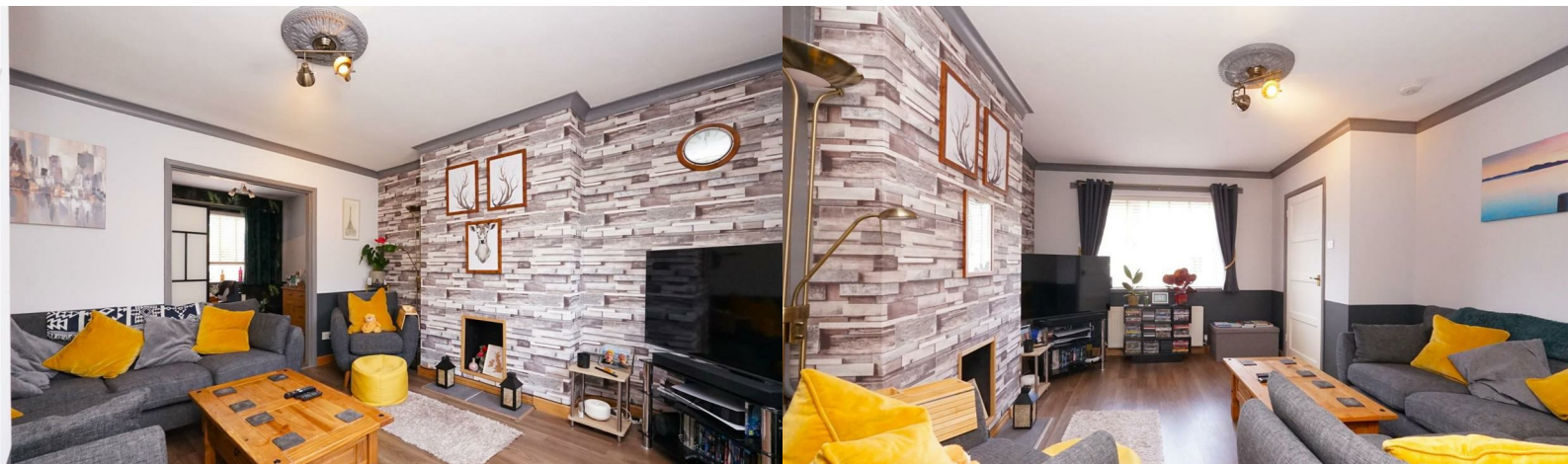

3 Maple Avenue

Ulverston, LA12 9JZ

Offers In The Region Of £195,000



Discover this beautifully modernised and extended 2-bedroom semi-detached home, perfectly positioned just a short walk from the town centre and local schools. Stylishly updated throughout, it offers comfortable, contemporary living in a sought-after location - ideal for first-time buyers, young families, or savvy investors. Don't miss your chance to make this move-in-ready gem your new home!

Step into the welcoming front courtyard and through the entrance into a spacious lounge, where natural light pours in, creating a warm and inviting atmosphere. The lounge opens seamlessly into a generous family dining area - perfect for entertaining or relaxed family meals.

From here, you're led into the extended, modern kitchen, featuring a stylish range cooker and plenty of workspace. This beautifully designed kitchen flows out to a generous rear garden, complete with a decked seating area and a lush lawn—ideal for outdoor dining and summer gatherings.

Upstairs, you'll find two light and airy double bedrooms, both tastefully decorated to offer a calm and restful space. The modern bathroom is fresh and bright, with contemporary tiling, a shower over the bath, and a clean, elegant finish throughout.

Entrance Hall

4'9" x 4'0" (1.453 x 1.244)

Living Room

13'0" x 12'2" (3.977 x 3.720)

Dining Room

8'7" x 8'4" (2.640 x 2.560)

Kitchen

12'9" x 6'1" (3.904 x 1.866)

Utility Area

8'4" x 6'3" (2.550 x 1.909)

Landing

6'10" x 5'3" (2.085 x 1.615)

Bedroom One

15'4" x 8'10" (4.698 x 2.710)

Bedroom Two

11'8" x 8'8" (3.559 x 2.644)

Bathroom

6'2" x 5'6" (1.897 x 1.677)



- Great Location
- Recently Extended & Renovated
- Excellent Family Home
- Council Tax Band A

- Close to Schools and Amenities
- Private Garden
- Tasteful Décor Throughout



Road Map



Terrain Map

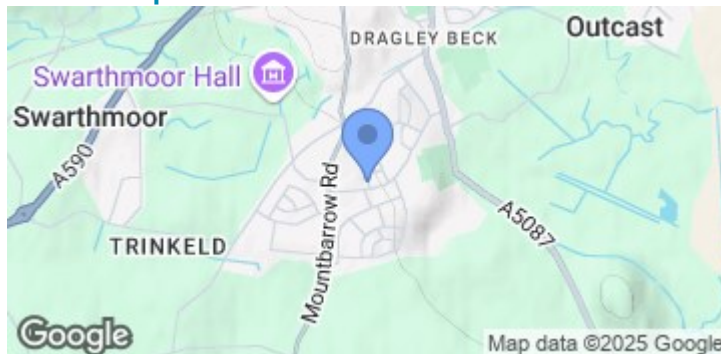

Floor Plan

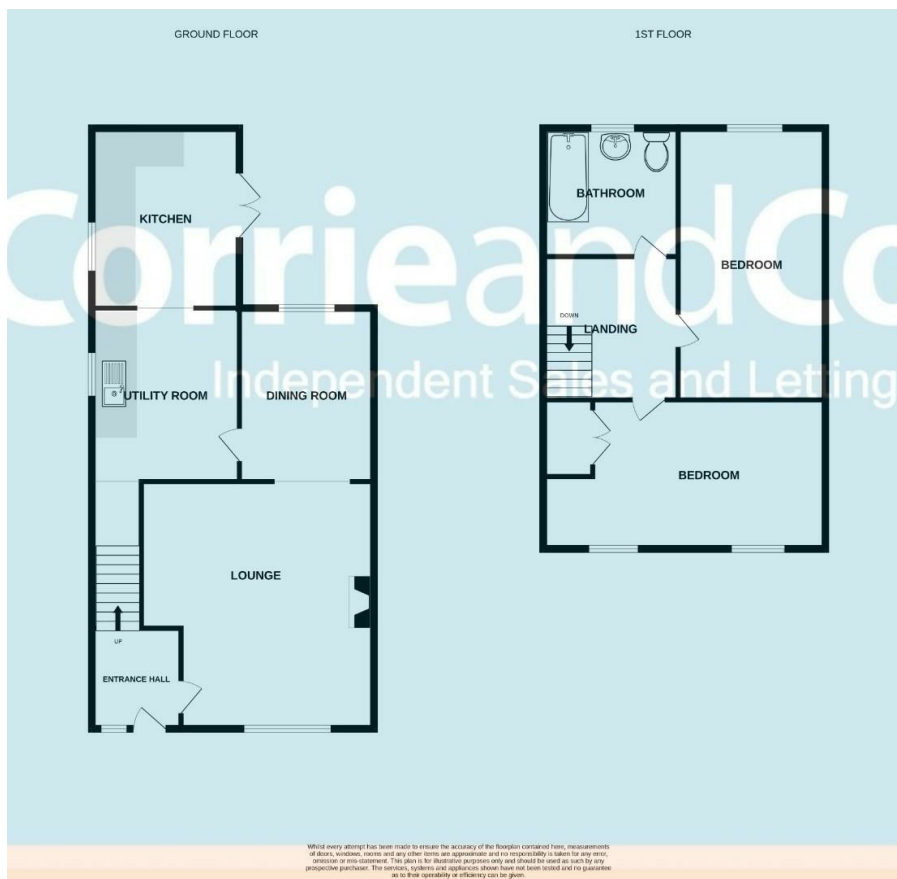

We are local, family run business who are wholly independent which means we can recommend services to most suit your needs. Our aim is to provide quality advice and expertise at all times, so you can make an informed decision whether buying or selling.

Estate agents are required by law to check a buyers /sellers identity to prevent Money Laundering and fraud. You do have to produce documents to prove your identity or address and information on your source of funds. Checking this information is a legal requirement to help safeguard your transaction, and failing to provide ID could cause delays. Corrie and Co, outsource these checks to speed up the process. The company does charge for such checks, please ask for more information and guidance on associated costs.

To ensure your move is stress free, we can help with Mortgage advice. We work alongside local Solicitors, offering competitive conveyancing services. Ask for further information.

